

INFRASTRUCTURE PROTECTION ACT 2017  
(ACT 41 OF 2017)

INFRASTRUCTURE PROTECTION  
(PROTECTED PLACES) (NO. A)  
ORDER 2020

ARRANGEMENT OF PARAGRAPHS

Paragraph

1. Citation and commencement
2. Premises declared to be protected place
3. Revocation

The Schedule

---

In exercise of the powers conferred by sections 14(1) and 19(1) of the Infrastructure Protection Act 2017, the Minister of Home Affairs makes the following Order:

**Citation and commencement**

**1.** This Order is the Infrastructure Protection (Protected Places) (No. A) Order 2020 and comes into operation on 2020.

**Premises declared to be protected place**

**2.** The premises described in the second column of the Schedule are declared to be a protected place for the purposes of the Act, and the person specified in the first column of that Schedule is designated as the authority of the protected place.

**Revocation**

**3.** The Protected Places (No. 2) Order 2005 (G.N. No. S 432/2005) is revoked.

---



---

**THE SCHEDULE**

| <i>First column</i>                  | <i>Second column</i>  |                 |                |           |           |           |           |           |           |           |           |           |           |           |           |           |           |           |           |           |           |
|--------------------------------------|---|-----------------|----------------|-----------|-----------|-----------|-----------|-----------|-----------|-----------|-----------|-----------|-----------|-----------|-----------|-----------|-----------|-----------|-----------|-----------|-----------|
| The Authority                        | Protected Place   |                 |                |           |           |           |           |           |           |           |           |           |           |           |           |           |           |           |           |           |           |
| Singapore Lubricant<br>Plant Manager | <p style="text-align: center;"><b>JURONG LUBRICANTS TERMINAL (EAST PLANT)</b></p> <p>All that area comprised in Lot 281V in Mukim No. 7 occupied by “JURONG LUBRICANTS TERMINAL (EAST PLANT)” containing an area of about 19186.8 square meters and bounded approximately as follows:</p> <p>Commencing at a point 31846.436 meters North and 12246.538 meters East of the Singapore Land Authority SVY 21 Datum, the boundaries run along successive lines of coordinates approximately as follows:</p> <table border="0" style="margin-left: auto; margin-right: auto;"> <thead> <tr> <th style="text-align: center;"><i>Northing</i></th> <th style="text-align: center;"><i>Easting</i></th> </tr> </thead> <tbody> <tr><td style="text-align: center;">31846.436</td><td style="text-align: center;">12246.538</td></tr> <tr><td style="text-align: center;">31658.701</td><td style="text-align: center;">12232.946</td></tr> <tr><td style="text-align: center;">31669.172</td><td style="text-align: center;">12088.573</td></tr> <tr><td style="text-align: center;">31760.051</td><td style="text-align: center;">12095.153</td></tr> <tr><td style="text-align: center;">31764.255</td><td style="text-align: center;">12108.242</td></tr> <tr><td style="text-align: center;">31776.894</td><td style="text-align: center;">12139.193</td></tr> <tr><td style="text-align: center;">31791.908</td><td style="text-align: center;">12169.137</td></tr> <tr><td style="text-align: center;">31809.162</td><td style="text-align: center;">12197.830</td></tr> <tr><td style="text-align: center;">31828.590</td><td style="text-align: center;">12225.152</td></tr> </tbody> </table> | <i>Northing</i> | <i>Easting</i> | 31846.436 | 12246.538 | 31658.701 | 12232.946 | 31669.172 | 12088.573 | 31760.051 | 12095.153 | 31764.255 | 12108.242 | 31776.894 | 12139.193 | 31791.908 | 12169.137 | 31809.162 | 12197.830 | 31828.590 | 12225.152 |
| <i>Northing</i>                      | <i>Easting</i>  |                 |                |           |           |           |           |           |           |           |           |           |           |           |           |           |           |           |           |           |           |
| 31846.436                            | 12246.538   |                 |                |           |           |           |           |           |           |           |           |           |           |           |           |           |           |           |           |           |           |
| 31658.701                            | 12232.946   |                 |                |           |           |           |           |           |           |           |           |           |           |           |           |           |           |           |           |           |           |
| 31669.172                            | 12088.573   |                 |                |           |           |           |           |           |           |           |           |           |           |           |           |           |           |           |           |           |           |
| 31760.051                            | 12095.153   |                 |                |           |           |           |           |           |           |           |           |           |           |           |           |           |           |           |           |           |           |
| 31764.255                            | 12108.242   |                 |                |           |           |           |           |           |           |           |           |           |           |           |           |           |           |           |           |           |           |
| 31776.894                            | 12139.193   |                 |                |           |           |           |           |           |           |           |           |           |           |           |           |           |           |           |           |           |           |
| 31791.908                            | 12169.137   |                 |                |           |           |           |           |           |           |           |           |           |           |           |           |           |           |           |           |           |           |
| 31809.162                            | 12197.830   |                 |                |           |           |           |           |           |           |           |           |           |           |           |           |           |           |           |           |           |           |
| 31828.590                            | 12225.152   |                 |                |           |           |           |           |           |           |           |           |           |           |           |           |           |           |           |           |           |           |

to the point of commencement.

The boundaries of “JURONG LUBRICANTS TERMINAL (EAST PLANT)” are more particularly delineated in Survey Plan No. 18082 filed in the office of the Chief Surveyor, Singapore, a copy of which is set out below.

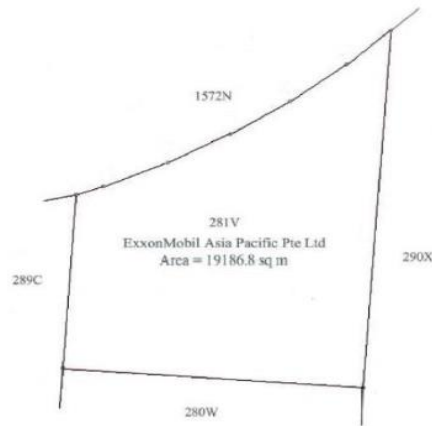

Survey Plan No: 18082

Made on 2020.

PANG KIN KEONG  
*Permanent Secretary,  
Ministry of Home Affairs,  
Singapore.*

[AG/LEGIS/SL/137B/2015/1 Vol. 4]

Note 1:LJH/PP (No. A) O 2020 (V06.05) ylp 4.3.20